

Campus Sustainability Fund

Committee Meeting Agenda & Minutes

Friday, 24th May 2024 | 2:30-4:30 pm PDT, Location: **Gerberding Hall**

Agenda		
Time	Item	Facilitator
2:30 - 3:00	Welcome!	Sohara
2:35-3:30	Grant Presentations & Voting Link to rubric Voting form	Boe/Sohara
3:30-4:00	Elections & Bylaw Changes & Committee feedback form	Tatiana/Boe
4:00 - 4:30	Commemorate work of departing committee members	Sohara

[Potential suggestions for committee roles](#)

Project Criteria Overview				
More detail on website				
<u>Criteria 1:</u> Sustainable Impact	<u>Criteria 2:</u> Leadership & Student Involvement	<u>Criteria 3:</u> Education, Outreach, & Behavior Change	<u>Criteria 4:</u> Feasibility & Accountability	<u>Criteria 5:</u> Budget
Projects must improve the sustainability of UW's campus and/or operations. Encompasses social sustainability, environmental sustainability, biodiversity, environmental justice and equity.	Projects must demonstrate some substantial degree of student leadership or student involvement throughout the application and implementation process to be considered for funding. Projects initiated by students will be prioritized.	Projects must include educational and outreach components that help cultivate an aware and engaged campus community.	Applicants must demonstrate appropriate knowledge, timelines, skills, and guidance complete projects successfully. CSF encourages mentor or department support and line item in the budget for project management.	Project must demonstrate a well-researched and feasible budget that accomplishes tasks and appropriately compensates the involved team members along with a timeline to implement the budget

<https://csf.uw.edu/how-apply/funding-guidelines>

Non Allowable Uses:

- *Funding cannot be used for time and labor expended by UW faculty working unless it is outside the scope of regular faculty duties.*
- *Funding cannot be used for the purchase of gift cards or other forms of compensation to research subjects. While we encourage compensating research subjects for their time, this must come from another funding source.*
- *In general, funds cannot be used for food, drinks, or salable merchandise as part of project budgets. Some exceptions may be granted.*
- *Line-item requests for travel funding are not encouraged, but will be considered on a case by case basis.*
- *Funds shall not be used for research projects unless such projects include an actionable component.*

CSF Bylaws + Protocols

[Committee Bylaws](#)

[Robert's Rules of Order](#)

[Liberating Structures](#)

[CSF Committee Google Drive](#)

[2023-2024 Committee Documents](#)

[Orientation Folder](#)

How to evaluate projects

[CSF Project Criteria](#)

[Reference Sheets](#)

[Evaluation Rubric Example \(go to Rubric Template tab\)](#)

Current projects + timeline

[Workday Orientation](#) - <https://tinyurl.com/csf-workday>

[2023-2024 Proposal Deadlines & Timeline](#)

[CSF Resource Guide](#)

Minutes

Attendees: Sohara, Sofia, Mazzi, Julia, Lauren, Tatiana, Boe, Danny, Azaan, Neha, Kort, Julie

- I. Salvage Wood presentation
 - A. Presented by Marlee, sustainability coordinator for the grounds crew at UW
 - B. Building an external shed for salvage wood, attached to Gould Hall
 - C. Sustainability solution: new revenue stream
 1. Implementing the program into CBE
 - a) Purchases boost revenue
 - b) Creates work orders
 - c) Creates foundation for campus expansion
 - D. Student involvement
 1. Getting more students involved and working hands on with the salvage wood
 2. Students enrolled in courses within CBE
 - a) Furniture design studio
 - (1) 14 students x 3 quarters = 42 students per year
 - b) Students can make personal purchases
 3. CSF purchases wood for 2 years
 - a) Alleviates cost burdens
 - b) After 2 years, students will have to purchase the wood but they will know their money is going towards sustainable wood sourcing and back into their campus
 4. Guided student tours of carpentry shop
 5. End of quarter final project event
 6. Eventually expand across campus
 - E. Education and outreach on campus
 1. Sustainability fair
 2. Earth Day Event
 3. Poster advertisements
 - a) Email to all CBE students prior to course registration every quarter telling them what classes will be using the salvage wood and how to get involved
 4. Reached out to
 - a) FMC: media blogger
 - b) UW News
 - c) Washington Magazine
 5. Creating interactive GIS map
 - a) Illustrating where the wood came from (pic of the tree)
 - (1) Following timeline of the wood
 - (a) More colleges might be interested in the future

- F. Without this program
 - 1. All trees removed would be discarded as green waste / wood chips
 - a) 19,000 board feet of wood salvaged since 2016
- G. Project longevity
 - 1. Legacy of contributing to UW's Sustainability Action Plan
 - 2. Build a solid foundation for campus-wide expansion
 - 3. Inventory process finalized and streamlined
 - 4. System will be established for transferring funds and wood
- H. Questions
 - 1. Cost of the wood vs buying externally
 - a) Lower rate than external, operating as a non-profit (just paying back carpenters)
 - b) More of a variety and unique species
 - (1) Reduced rate
 - (2) These species would be much more expensive at an external lumber yard
 - 2. Question about the budget for the student tours?
 - a) Paying the carpenters for their time
 - (1) Otherwise they would be charging the overhead budget (which is meant to be for the maintenance and preparation of the wood)
 - 3. Question about two years from now
 - a) CBE could purchase the wood for the students to fund the carpenters, otherwise would be students purchasing the wood to pay for the carpenters

II. Yoshino Cherries

- A. Presented by biology professor Adam Steinbrenner
- B. Lab studies the genetics of plant stress responses
 - 1. Recent paper: plant genome sequences can help us understand the evolution of resilience to stress
- C. How can plant genomics help us understand the Quad cherries?
 - 1. Every Yoshino is a clonal cutting from a small number of original hybrid trees from Japan
 - 2. Nurseries graft Yoshino top onto a different species' rootstock, this leads to fast growth but short life
 - 3. It is thought that the Quad cherries are so old because they are not grafted
 - 4. Yoshino cherry is a hybrid between two other cherry species
 - 5. Japanese researchers have sequenced 46 Yoshinos. If we know our trees' genome sequence, we can relate them to the original clones, advancing cultural sustainability
 - 6. Use genomic data to infer how trees may be adapted to climate change

7. Cherry trees are the center of campus community and culture
- D. Project input from campus tree and outreach experts
 1. Sara Shores, UW Grounds and Arborist
 2. Others
- E. Project is an opportunity to emphasize the ecosystem services of the Yoshino cherries
- F. Planned project activities
 1. Collect leaf material for sequencing
 2. Complete DNA sequencing
 3. Student-led bioinformatic analysis
 4. Prepare slide presentation
 5. Prepare public flyer
 6. Prepare recommendations for cherry tree conservation
- G. Questions
 1. Intern?
 - a) Undergrad research intern for the summer
 2. Question about conservation of trees
 3. Replacement trees?
 4. Student involvement?
 - a) Lauren suggested including this in classes and Adam liked the idea (and hadn't thought of it)
 - b) Dawg days
 5. Mazzi question about equipment
 - a) Equipment is single-use
 - (1) Kind of like a film cartridge to a camera
 6. Education and outreach
 - a) Teaching people to take care of the trees
 - b) Trees are a way for people to connect to UW campus

Timeline of our Yoshino cherries

1936: A gift of cherries to the city of Seattle, possibly from the city of Yokohama near Tokyo.

1961: Trees are transplanted to the UW Quad

2000: 5 replacement trees are planted but some have not survived

2025: Sequenced genomes for future conservation?

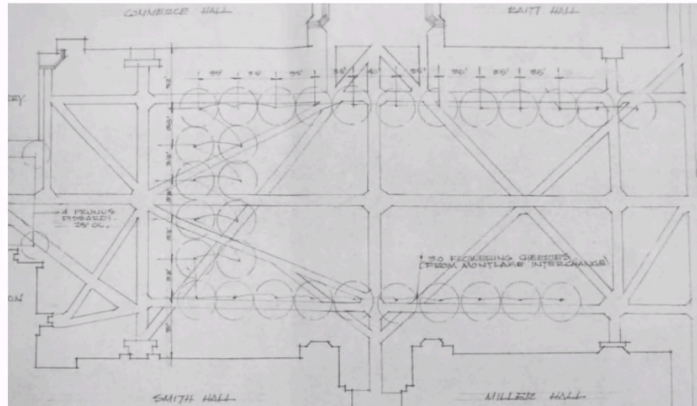
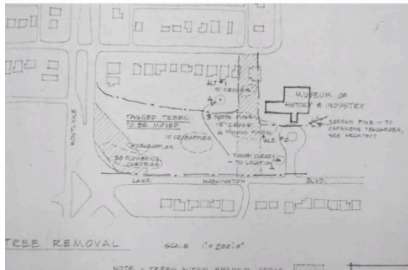

Shiotani 2019 "History of the Cherry Trees in the Liberal Arts Quadrangle at the University of Washington"

Dec 15 1961

Planned project activities

Task	Timeframe	Major activities	HudsonAlpha ACTG Contribution:
Collect leaf material for sequencing	Summer 2024	Steinbrenner lab graduate student involvement	
Complete DNA sequencing (HudsonAlpha Institute, Huntsville AL)	Fall 2024- Winter 2025	Recruit a student to receive \$5000 research stipend for Summer 2025 Internship - \$10,000 for lab supplies - BIOL400 / 426	- \$7000 in additional sequencing facility costs
Student-led Bioinformatic analysis	Spring-Summer 2025	Summer intern will work with graduate students	- 40 hours of project support from full-time project manager Austin Osmanski (~\$8000)
Prepare slide presentation	Spring-Summer 2025	Publish via webpage + Google Slides - On-campus presentations, Dawg Days	
Prepare public flyer	Spring-Summer 2025	Summer intern will work with Visitor Center with \$1500 budget	
Prepare recommendations for cherry tree conservation	Summer 2025	- Coordinate with cherry adaptation studies Steinbrenner lab will retain genomic information to work with future researchers	

III. Designing a Bird Friendly Campus - phase 2

A. Phase 1

1. Data collection
2. Student involvement
3. Campus engagement

- B. Loss of campus biodiversity
 - 1. 29 species among found collision victims
 - 2. Over half of found species are in decline
 - 3. Thrush family of species is most vulnerable to collisions
- C. Effective design solutions communicate to birds that glass surfaces are solid
 - 1. Breaking up the glass surface area
 - 2. Patterns spaced closely enough that they appear solid
 - 3. Spacing patterns every 2 inches
- D. Avian Impact app
 - 1. First bird-building collision tracking app
 - 2. Citizen science
- E. Questions
 - 1. Working with building managers and differences in buildings
 - a) Managers are excited to have treatments on buildings
 - (1) Like that they are treating hotspots
 - 2. Historical landmarks?
 - 3. Speaking more about how the retrofitting impacts the inside of the building
 - a) More shading effect
 - 4. Feather-friendly
 - a) On 50 dif college campuses in the US
 - b) Used worldwide
 - c) Guaranteed for 25 (?) years
 - 5. LEED certified buildings account for 53% of total collisions
 - a) LEED and green buildings are very behind, very human-centric

IV. [Bylaw changes](#)

- A. Making chair and vice chair positions more equal
- B. Both 40 hours a quarter
 - 1. quarterly stipend of \$1,200 for a gross total of \$4,800 over the course of the academic year (4 quarters)
- C. Chair
 - 1. Meets with CSF grant and project coordinator to prepare
- D. Adding more responsibilities to vice chair
- E. Members will offer key insight and serve on sub-committees as organized
 - 1. Each member is still expected to work 20 hours per quarter
- F. Pays are above what is minimum required, we have wiggle room
- G. Vote passes to change the bylaw

- V. Boe is sending out anonymous committee feedback forms next week